

2/3"200万像素级定焦镜头 600000

2/3" 2MP C M-Iris

2百万像素系列工业镜头
 C接口, 可支持2/3"传感器
 适用于工业自动化批量使用



| No | 项目 | 规格 |
|----|----------------|--|
| 1 | 最大传感器尺寸 | 2/3"(11mm) |
| 2 | 焦距 | 12mm |
| 3 | 接口 | C-Mount |
| 4 | F/# | F1.4-C |
| 5 | 工作距离 | 0.15m~∞ |
| 6 | 视场角(对角×水平×垂直) | 2/3" 49.0°×40.0°×30.3° |
| | | 1/2" 36.5°×29.4°×22.2° |
| | | 1/3" 27.6°×22.2°×16.7° |
| 7 | 对象大小(在最近对焦距离处) | 2/3" 152.1×120.3×89.3mm |
| | | 1/2" 108.9×86.6×64.6mm |
| | | 1/3" 81.0×64.6×48.3mm |
| 8 | 后焦距 (in air) | 12.70mm |
| 9 | 操作方式 | 对焦 手动 光圈 手动 |
| | 畸变率 | 2/3" -1.8%@y=5.5mm 1/2" -1.25%@y=4.0mm 1/3" -0.78%@y=3.0mm |
| 11 | 滤镜尺寸 | M30.5×0.5mm |
| 12 | 镜头尺寸(宽×长) | 38.5×39.68mm |
| 13 | 重量 | 71g |
| 14 | 工作温度 | -10°C~+50°C |
| 15 | 入瞳距离 | 17.87mm |
| 16 | 入瞳直径 | 8.60mm |
| 17 | 出瞳距离 | -40.98mm |
| 18 | 出瞳直径 | 28.39mm |
| 19 | 光学总长 | 46.20mm |
| 20 | 放大倍率 | -0.075 |

| 对焦距离 | 放大倍率 | 前景深(mm) | 后景深(mm) |
|-------|----------|---------|---------|
| 150mm | -0.07489 | 1.3850 | 1.4634 |
| 200mm | -0.05747 | 4.2177 | 4.4034 |
| 250mm | -0.04659 | 6.5556 | 6.9184 |
| 300mm | -0.03918 | 9.3908 | 10.0180 |
| 350mm | -0.03380 | 12.7160 | 13.7120 |
| 400mm | -0.02972 | 16.5220 | 18.0100 |
| 450mm | -0.02651 | 20.8040 | 22.9230 |
| 500mm | -0.02394 | 25.5520 | 28.6410 |
| 550mm | -0.02181 | 30.7610 | 34.6350 |
| 600mm | -0.02004 | 36.4230 | 41.4560 |

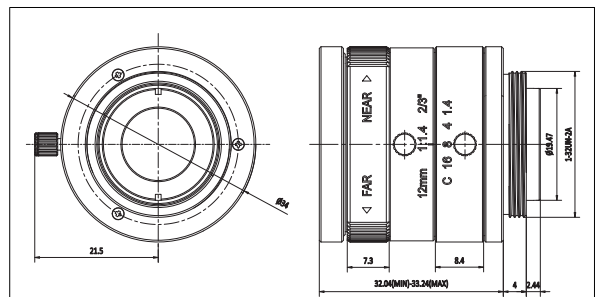

CRA

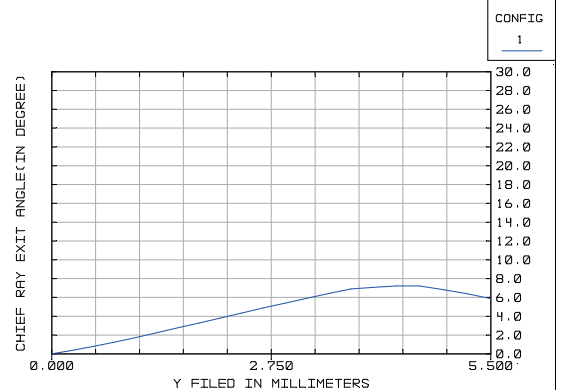

MTF

